

11/26/2018 11:26:20 AM  
Plotted On: Nov 26, 2018 12:40pm By: wechamps@t  
Tighe & Bond: J:\S\S2087 Stamford\033 Mold Remediation Consulting\Sites\Rogers International\Drawings\CAD\Rogers Mold Remediation.dwg

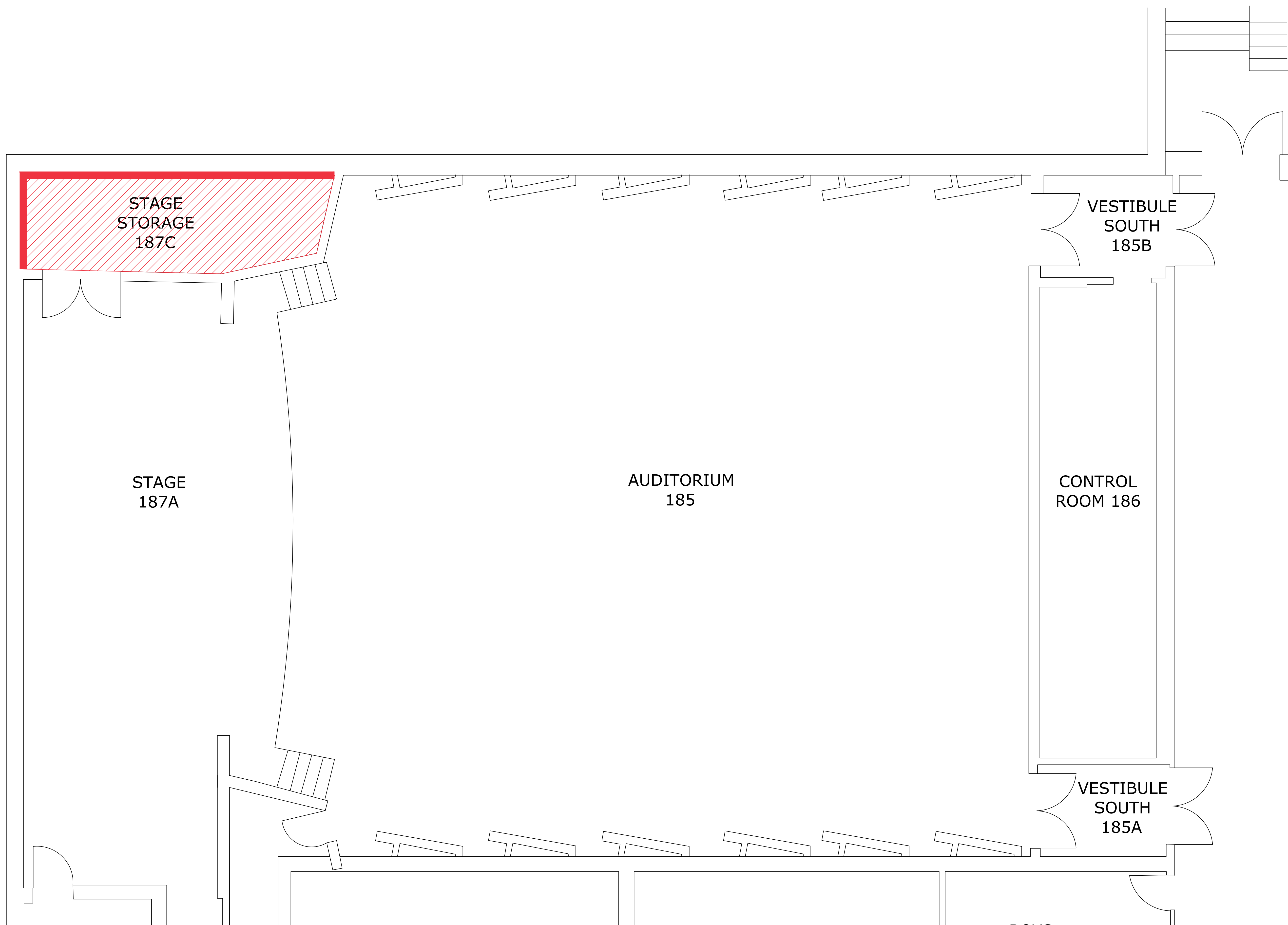

— = BLACK GROWTH ON GYPSUM BOARD. (APPROXIMATELY 750 SQUARE FEET)

**Rogers  
International  
School**

City of Stamford

Stamford, CT

MARK	DATE	DESCRIPTION
PROJECT NO: S2087		
DATE: 11/26/2018		
FILE: Rogers Mold Remediation.dwg		
DRAWN BY: WAC		
CHECKED: XX		
APPROVED: XX		

Figure 1.1

SCALE: NOT TO SCALE

GROWTH REMOVAL WORK PLAN