

TOP NAME: 525-535 HOPE STREET - STAMFORD, CT  
 APEX LIGHTING SOLUTIONS  
 REFLECTANCES: N/A  
 MOUNTING HEIGHT: @ GRADE  
 MOUNTING HEIGHT: SEE LUMINAIRE SCHEDULE  
 APEX: CTR  
 SHEET: SL-1E

Luminaire Schedule	Qty	Label	Arrangement	Lumens	Input Method	LLF	EMG Rating	Description
SL4HS	2	SL4HS	SINGLE	5772	55.7	0.850	B1-U0-G1	GABDCO BCE-S-32L-530-WM-G2-AR-2-VOLT-HIS-FINISH MOUNTED TO SSSI-0-4-11-01-FINISH @ 10FT AFG TO BOP
SL4HS	3	SL4HS	SINGLE	6048	55.7	0.850	B1-U0-G2	GABDCO BCE-S-32L-530-WM-G2-AR-4-VOLT-HIS-FINISH MOUNTED TO SSSI-0-4-11-01-FINISH @ 10FT AFG TO BOP
M4	38	M4	SINGLE	4712	55	0.850	B1-U0-G1	GABDCO 101L-16L-1000-WM-G1-4-VOLT-FINISH WALL MOUNTED @ 11FT AFG TO BOP

Calculation Summary	Grid 2	Avg	Max	Min	Avg/Min	Max/Min
Label	Grid 2	Avg	Max	Min	Avg/Min	Max/Min
Qty	0	1.31	14.2	0.0	N.A.	N.A.
Site		3.64	14.2	0.0	N.A.	N.A.
Parking Lot						

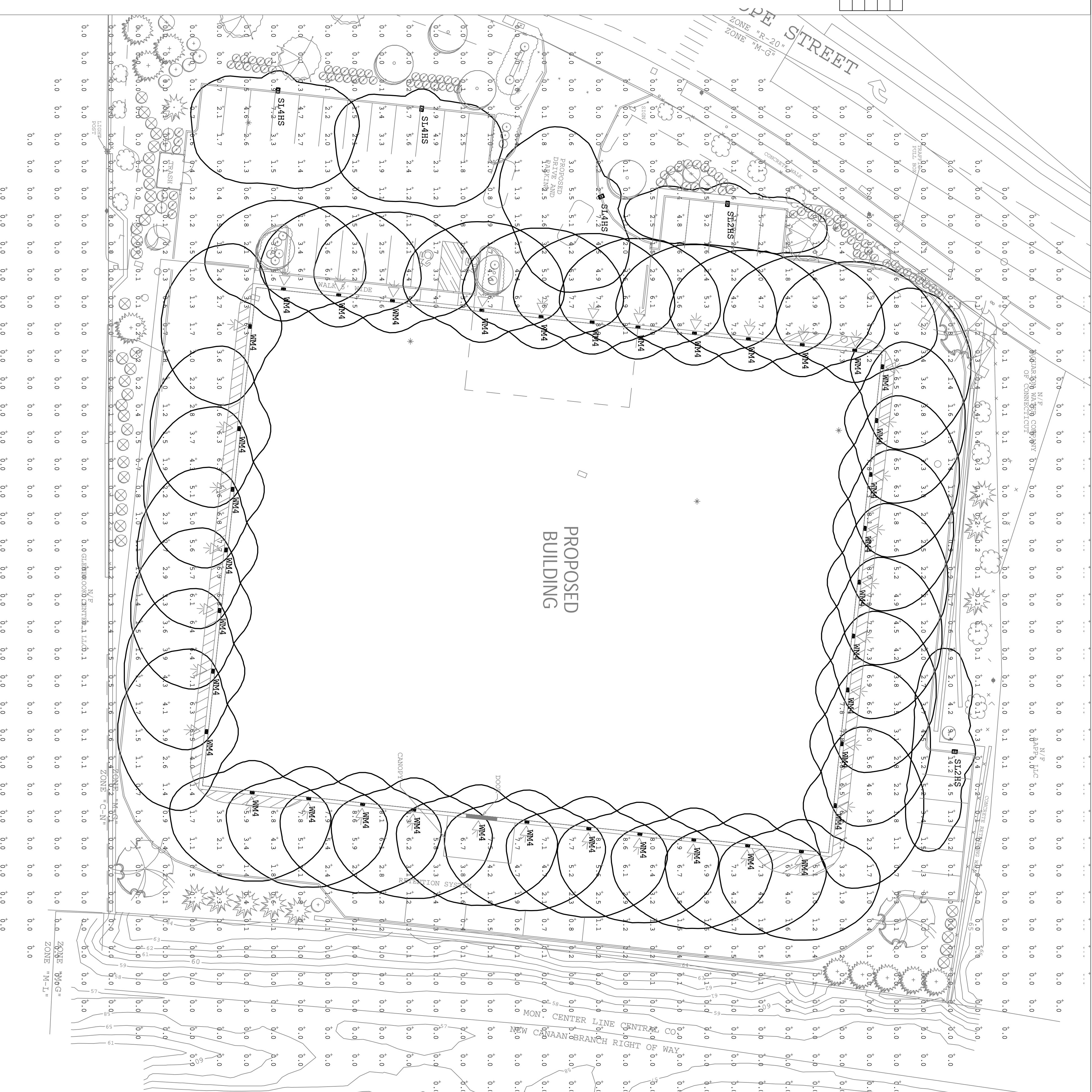

**GENERAL DISCLAIMER:**  
 Calculations have been performed according to IES standards and good practice. The lighting design is based on the information provided and is subject to change based on field conditions. The lighting design is based on the information provided and is subject to change based on field conditions. The lighting design is based on the information provided and is subject to change based on field conditions.

**NOTE TO REVIEWER:**  
 Total Light Loss Factor (LLF) applied at time of design is determined by applying the Lamp Lumen Depreciation (LLD) from current lamp manufacturer's catalog and a Ballast Factor (BF) from current ballast Specification. The resulting LLF value will not accurately depict actual results. It is essential that you insist all designers use correct Light Loss Factors.

**NOTE TO REVIEWER:**  
 LLF Determined Using Current Published Lamp Data

**REVISIONS:**

REV. X XX-XX-XX XXXX

**PROJECT TITLE:**  
 525-535 HOPE STREET  
 STAMFORD, CT

**DRAWING TITLE:**  
 EXTERIOR LIGHTING  
 PHOTOMETRIC CALCULATION

SCALE: 1"=20'-0"

DATE: 4/23/21

DRAWN BY: CTR

SHEET:

SL-1E

FILE NAME: SL-1E-525-535 HOPE STREET STAMFORD CT 4-23-21 CTR.dwg

