



INSTR # 2018000850
VOL 11880 PG 234
RECORDED 01/19/2018 12:58:01 PM
LYDA RUIJTER
CITY & TOWN CLERK STAMFORD CT
BLOCK 30

PLANNING BOARD DECISION

MP-427 PLANNING BOARD CERTIFICATE

I, THERESA DELL, Chair of the Planning Board of the City of Stamford, in compliance with Special Act No.619 of the 1953 General Assembly, hereby certify that on January 9, 2018, a Public hearing was held by the **PLANNING BOARD** to consider an amendment to the 2015-2025 Master Plan of the City of Stamford upon application of:

ACCURATE REAL ESTATE HOLDINGS TWO, LLC; JOS, LLC; JOYCE DICAMILLO HOFFMEISTER & GLORIA DICAMILLO SINAGUGLIA C/O AGENT: WILLIAM J. HENNESSEY, JR. OF CARMODY TORRANCE SANDAK & HENNESSEY LLP

and that the following is a statement of its decision as follows:

APPROVED on January 9, 2018 the following change to the 2015-2025 Master Plan and Text of the City of Stamford as follows:

Change from Master Plan Category #6 (Commercial-Neighborhood) to Master Plan Category #13 (Industrial - General) for certain property generally described as follows:

Block #: 30

Area: ±1.2 acres

Description:

All those certain parcels of land situated in the City of Stamford, County of Fairfield, and State of Connecticut, said parcel of land being more particularly bounded and described as follows:

Beginning at a point on the centerline of West Avenue, where the same is intersected by the extended centerline of Annie Place, then bounded as follows:

Northerly, 85 feet, more or less, along the centerline of said West Avenue;

Easterly, 142 feet, more or less, through West Avenue and by land of 480 WM Realty LLC, now or formerly, each in part;

Northerly, 60 feet, more or less, by land of 480 WM Realty LLC, now or formerly;

Easterly, 133 feet, more or less, by land of Barton Properties Connecticut LLC and Four 58 Main Street LLC, now or formerly, each in part;

Southerly, 67 feet, more or less, by land of V & J Realty LLC, now or formerly;

Easterly, 205 feet to the centerline of Diaz Street, more or less, by land of V & J Realty LLC, now or formerly, and Diaz Street, each in part;

Southerly, 100 feet, more or less, along the centerline of Diaz Street;

Westerly, 207 feet, more or less, through Diaz Street, and by land of Martha S. Bria TR Et Al, now or formerly, to the easterly terminus of Annie Place;

Northerly, 22 feet, more or less, along the easterly terminus of Annie Place;

Westerly, 278 feet, more or less, along the centerline of Annie Place to the centerline of West Avenue and the point and place of beginning;

containing approximately 1.2 Acres of land.

The subject properties for which the application has been approved are generally shown and delineated on the sketch set forth below:

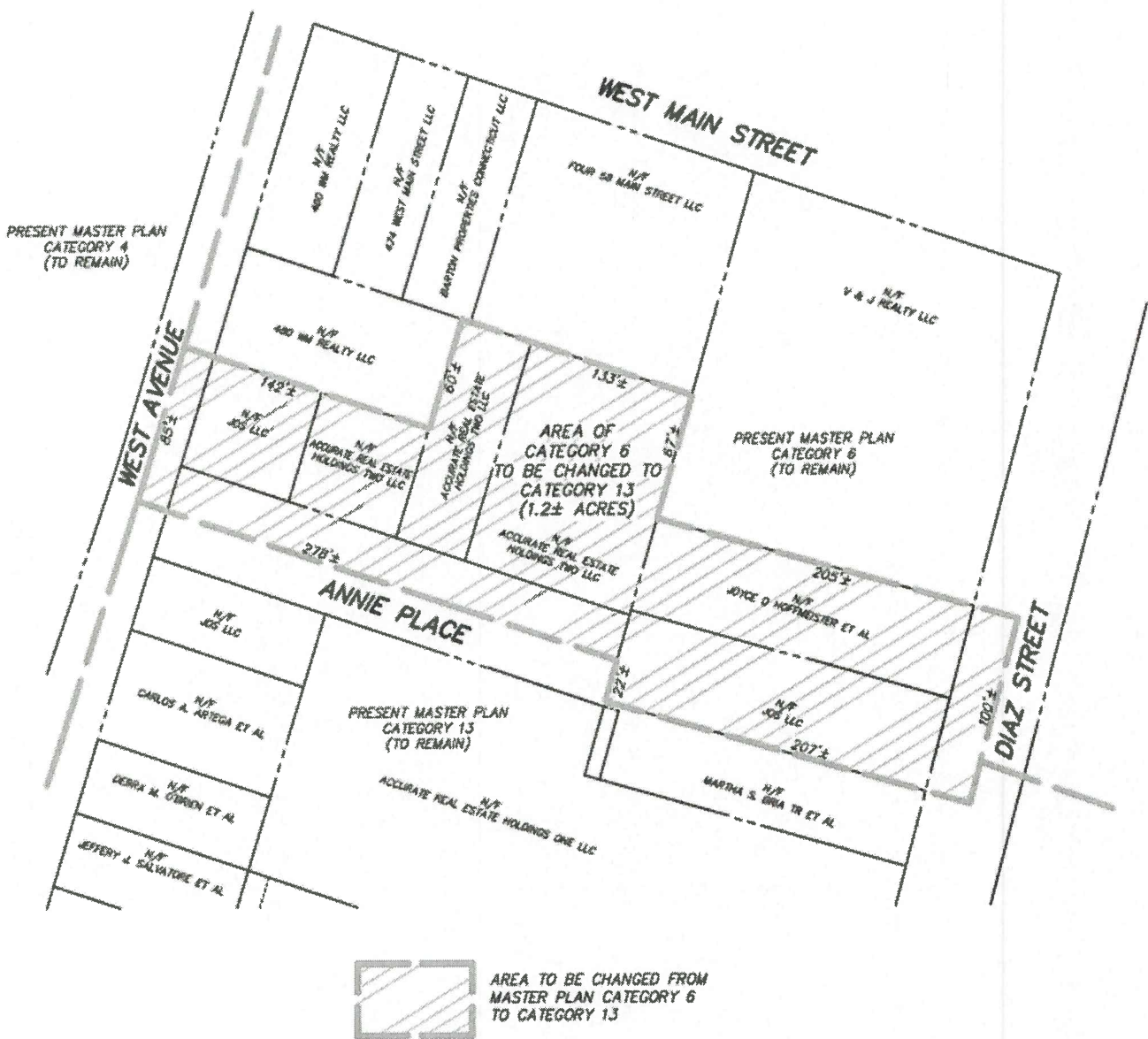

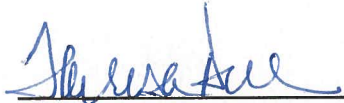
ATTEST: THERESA DELL, CHAIR
STAMFORD PLANNING BOARD

Dated at the City of Stamford, Connecticut, this 19th day of January, 2018.