

MAYOR  
CAROLINE SIMMONS

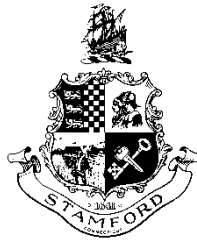

PURCHASING MANAGER  
ERIK J. LARSON  
Phone: (203) 977-4107  
Email: elarson@stamfordct.gov

**CITY OF STAMFORD**  
**OFFICE OF ADMINISTRATION**  
888 WASHINGTON BOULEVARD  
P.O. BOX 10152  
STAMFORD, CONNECTICUT 06904-2152

**ADDENDUM NO. 2**  
**(October 4, 2022)**

**Request for Proposals No. 885**  
**Architectural/Engineering Design Services for New Animal Control Center**

Addendum No. 2 is being issued to all potential respondents to provide the items and attachments set forth herein which shall act to qualify, clarify, or otherwise modify the RFP Documents previously issued regarding the above referenced project. These items, whether of omission, addition, substitution, or clarification, shall be incorporated into the proposals submitted by all bidders, and receipt of this document and its attachments should be acknowledged in the space provided on the RESPONDENT'S INFORMATION AND ACKNOWLEDGEMENT FORM. Failure to do so may subject the Bidder to disqualification.

The items and references are:

- Attached is a draft copy of the survey.
- The bids are postponed with a new due date as follows - **RFP Opening: October 6, 2022** October 13, 2022 at 4:00 PM.

All other terms and conditions of **RFP No. 885** remain the same.

Erik J. Larson  
Purchasing Agent

Cc: Lyudmila Fuks, Staff Engineer  
Purchasing Department File

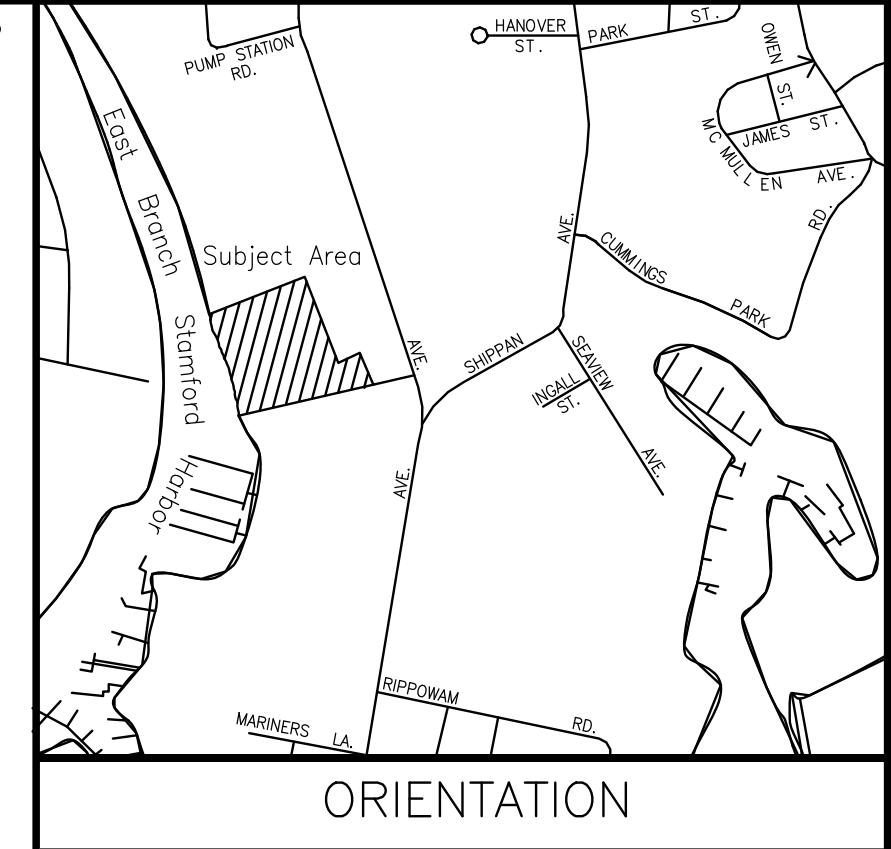

LEGEND

- ☆ Light Pole/Post
- WB ◯ Water Box
- WM ◯ Water Meter Pit
- ▲ Hydrant
- GB ◯ Gas Box
- ⊥ Sign
- MH Manhole
- CB Catch Basin
- E Electric
- T Telephone
- C Cable
- Bollard
- ⊗ Tree

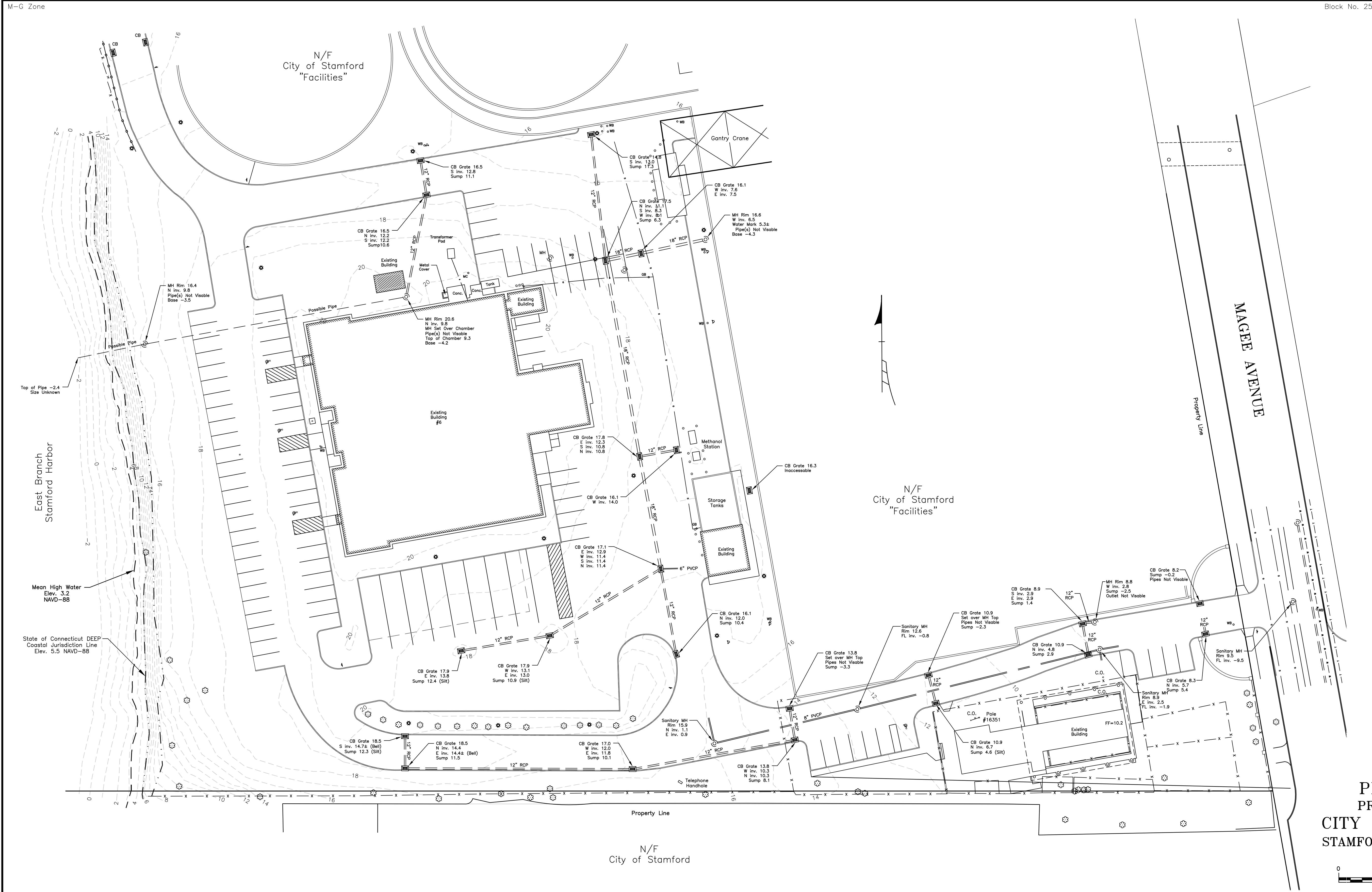

**PLOT PLAN  
PREPARED FOR  
CITY OF STAMFORD  
STAMFORD, CONNECTICUT**

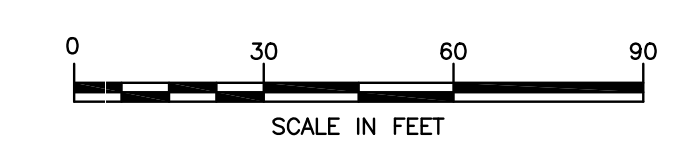

- NOTES:
- Elevations based on NAVD-88.
  - Underground utility, structure and facility locations depicted and noted hereon have been compiled, in part, from record mapping supplied by the respective utility companies or governmental agencies, from parcel testimony and from other sources. These locations must be considered as approximate in nature. Additionally, other such features may exist on the site, the existence of which are unknown to Edward J. Frattaroli, Inc. The size, location and existence of all such features must be field determined and verified by the appropriate authorities prior to construction.
  - The contractor shall notify all public utility companies by calling Call-Before-You-Dig at 1-800-922-4455 at least 48 hours prior to crossing their lines.

**DRAFT COPY. NOT FOR CONSTRUCTION**

This survey and map has been prepared in accordance with Sections 20-300b-1 thru 20-300b-20 of the Regulations of Connecticut State Agencies—"Minimum Standards for Surveys and Maps in the State of Connecticut" as endorsed by the Connecticut Association of Land Surveyors, Inc. It is a "IMPROVEMENT LOCATION PLAN" based on a "RESURVEY" conforming to Horizontal Accuracy Class "A-2"; Vertical Accuracy "V-2" and intended to depict limited existing conditions.

To my knowledge and belief this plan is substantially correct as noted hereon.

BY:  
**FOR: EDWARD J. FRATTAROLI, INC.**  
Land Surveyors • Engineers • Land Planners  
STAMFORD, CONNECTICUT Oct. \_\_, 2022

This Document and Copies Thereof are Valid only if they bear the signature and embossed seal of the designated licensed professional. Unauthorized alterations render any declaration hereon null and void.