

ELEVATION  
SCALE 3/16" = 1'-0"  
0' 2' 4' 8'

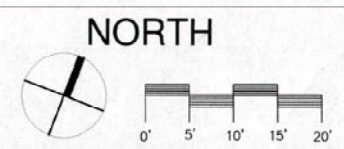

Sketch Concept Plan			MAIN STREET BRIDGE REPLACEMENT		
			MAIN STREET BRIDGE NO. 02212		
			OVER THE RIPPOWAM RIVER		
			CITY OF STAMFORD, ENGINEERING BUREAU		
			Aris Land Studio		
			78 Elm Street		
			Bridgeport, CT 06604		
			203.606.3130 www.ArisLS.com		
		DATE:	ISSUED FOR:	DWG. No.:	
		12-12-2018	CITY REVIEW	LA-1	
		AL5 CONTRACT NO. 18-322	DRAWN BY:	SCALE: 1" = 10', or as Noted	

Copyright © 2018 Aris Land Studio, LLC. All rights reserved. No part of these documents may be reproduced in any form or by any means without the written permission of Aris Land Studio, LLC.



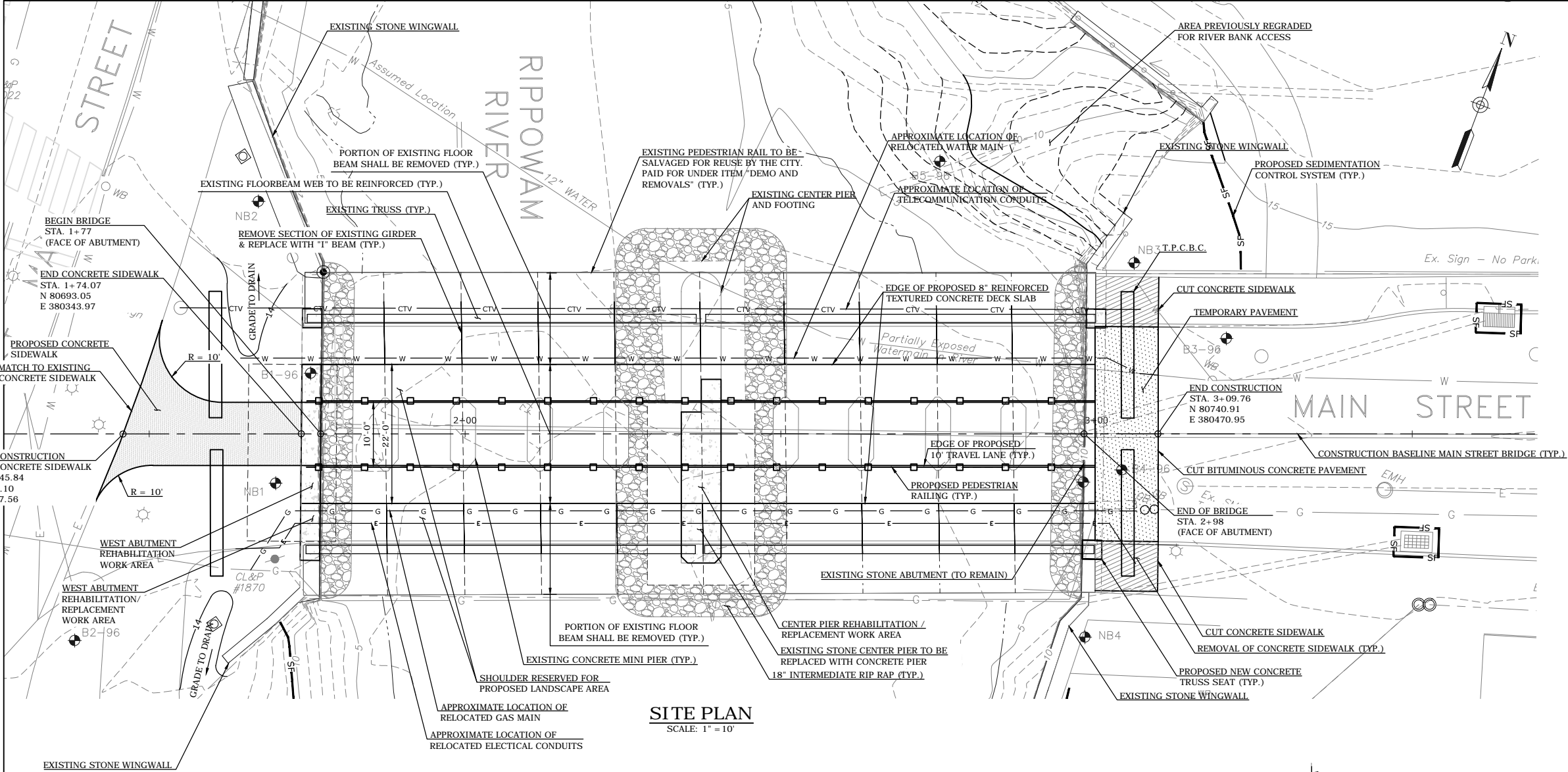

- CONSTRUCTION NOTES:**
1. ALL ROADWAY SIGNS AND FENCES DISTURBED OR REMOVED DURING CONSTRUCTION SHALL BE RESET AS NECESSARY. (PAID FOR UNDER "CLEARING AND GRUBBING".)
  2. EFFLUENT FROM DEWATERED WORK AREA(S) SHOULD NOT BE DISCHARGED DIRECTLY TO THE STREAM BUT MUST BE PROCESSED THROUGH TREATMENT STRUCTURE(S). SUCH STRUCTURE(S) SHOULD NOT BE LOCATED WITHIN THE STREAM CHANNEL OR ADJACENT WETLANDS.
  3. ALL APPROPRIATE EROSION AND SEDIMENT CONTROL MEASURES SHOULD BE ESTABLISHED PRIOR TO AND MAINTAINED THROUGHOUT ALL CONSTRUCTION PHASES.
  4. ANY ACTIVITIES OTHER THAN THOSE SHOWN ON THE PLANS OR DETAILED IN THE WETLANDS PERMIT THAT OCCUR IN THE REGULATED WETLANDS AREA SHALL BE SUBJECT TO APPROVAL BY THE LOCAL INLAND/WETLANDS AUTHORITY OR ITS DESIGNATED REPRESENTATIVE.
  5. DURING ALL PHASES OF CONSTRUCTION ACTIVITIES, ACCESS FOR THE PROPERTY OWNERS AS WELL AS ALL SERVICE VEHICLES SUCH AS MAIL, TRASH COLLECTION, FUEL DELIVERIES, ETC. SHALL BE MAINTAINED BY THE CONTRACTOR TO ABUTTING PROPERTIES WITHIN THE LIMITS OF THE WORK.
  6. SURVEY INCLUDING WETLAND FLAG LOCATIONS, PERFORMED BY O'BRIEN ASSOCIATES INC. MIDDLETOWN, CT.

**SITE PLAN**  
SCALE: 1" = 10'

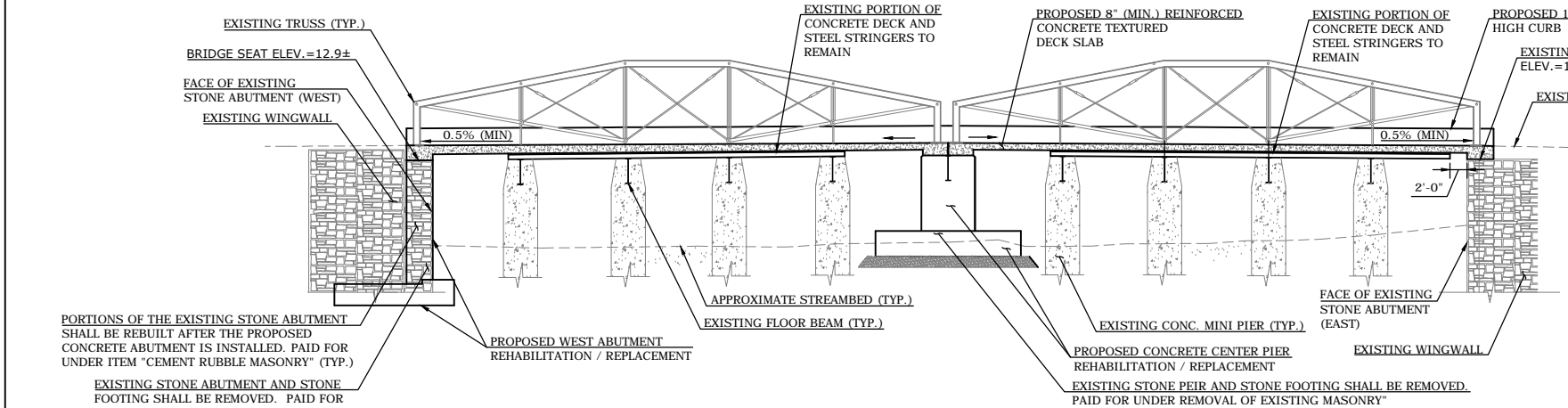

**STRUCTURE ELEVATION  
(LOOKING UPSTREAM)**  
SCALE: 1" = 10'

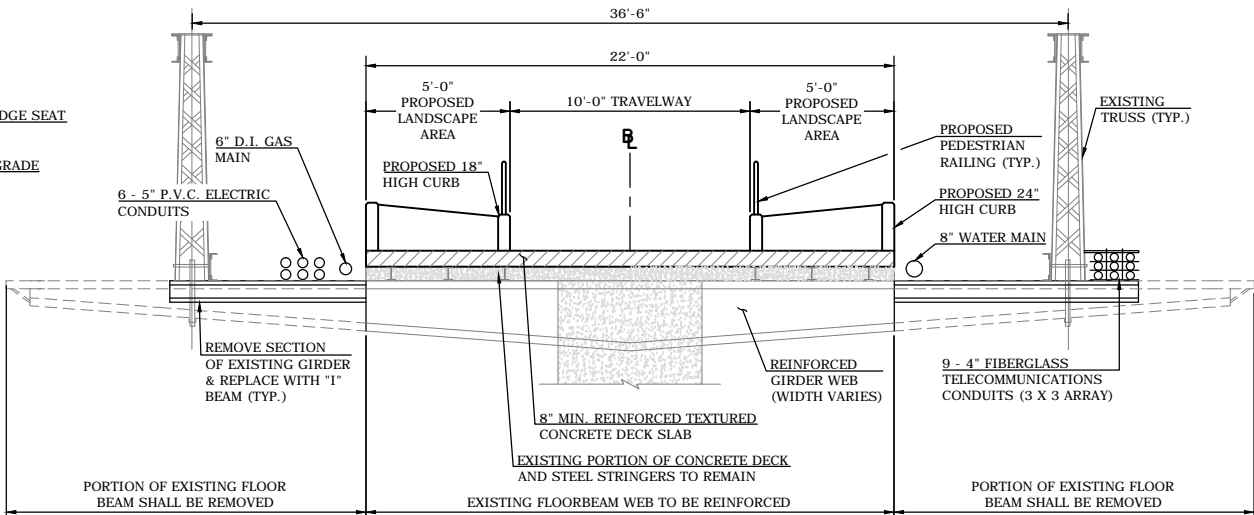

**BRIDGE SECTION**  
SCALE: 1" = 4'

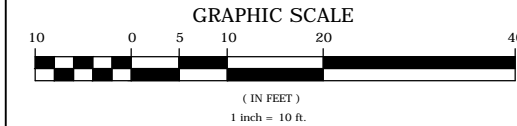

**SURVEY NOTES:**  
HORIZONTAL DATUM: CGS DATUM  
HORIZONTAL ACCURACY: CLASS A-2  
VERTICAL DATUM IS: NGVD29  
VERTICAL ACCURACY: CLASS T-2

		SUPV.	J.A.C.
		DESIGN	J.A.W.
		DRAWN	S.A.M.
		CHECKED	J.A.W.
NO.	DATE	DESCRIPTION	DATE
		REVISIONS	12/20/2018

PE SUBMITTAL

1/2 SCALE  
(11X17)



WENGELL, McDONNELL & COSTELLO  
87 HOLMES ROAD  
NEWINGTON, CT 06111  
(860) 667-9624

PREPARED FOR  
CITY OF STAMFORD  
888 WASHINGTON BOULEVARD  
STAMFORD, CT. 06901

WEST MAIN STREET PEDESTRIAN BRIDGE  
MAIN STREET BRIDGE NO. 02212  
OVER RIPPOWAM RIVER  
STRUCTURE PLAN, ELEVATION AND SECTION

D - MAIN STREET - P.E. - 18068.00 - SHEET A1  
SIZE PROJECT FILE NAME NUMBER REV. OF 5

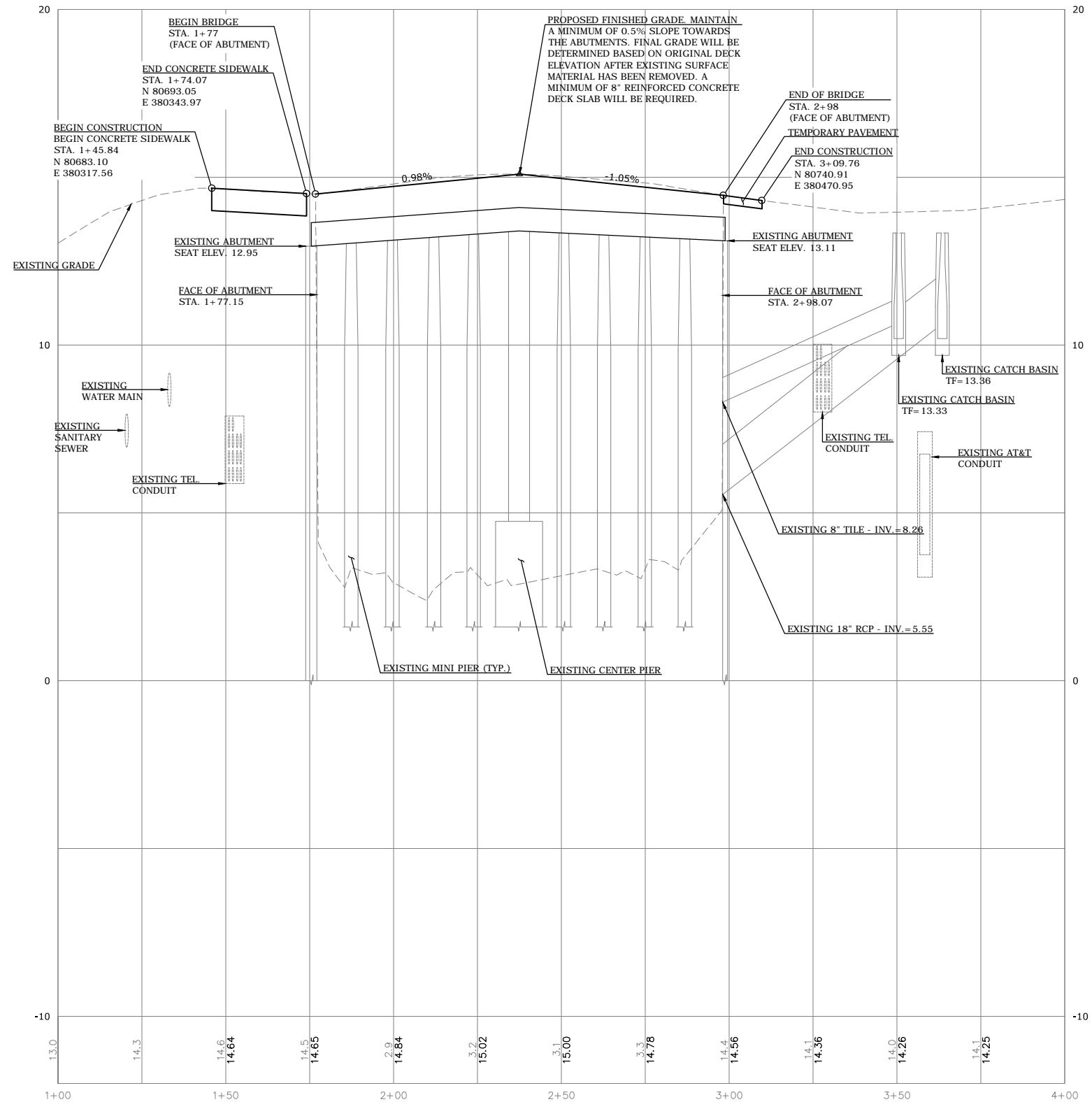

PROPOSED ROADWAY PROFILE

HORIZONTAL SCALE: 1"=20'  
VERTICAL SCALE: 1"=2'

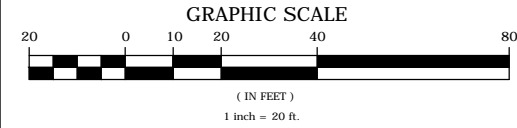

			SUPV.	J.A.C.
			DESIGN	J.A.W.
			DRAWN	S.A.M.
			CHECKED	J.A.W.
NO.	DATE	DESCRIPTION	DATE	12/20/2018
REVISIONS				

PE SUBMITTAL

1/2 SCALE  
(11X17)

WMC

CONSULTING ENGINEERS

• WENGELL, McDONNELL & COSTELLO •  
87 HOLMES ROAD  
NEWINGTON, CT 06111  
(860) 667-9624

PREPARED FOR  
CITY OF STAMFORD  
888 WASHINGTON BOULEVARD  
STAMFORD, CT. 06901

WEST MAIN STREET PEDESTRIAN BRIDGE  
MAIN STREET BRIDGE NO. 02212  
OVER RIPPOWAM RIVER  
PEDESTRIAN BRIDGE PROFILE

D - MAIN STREET  
SIZE PROJECT

- P.E. - 18068.00  
FILE NAME NUMBER

-  
REV.

SHEET A2  
OF 5

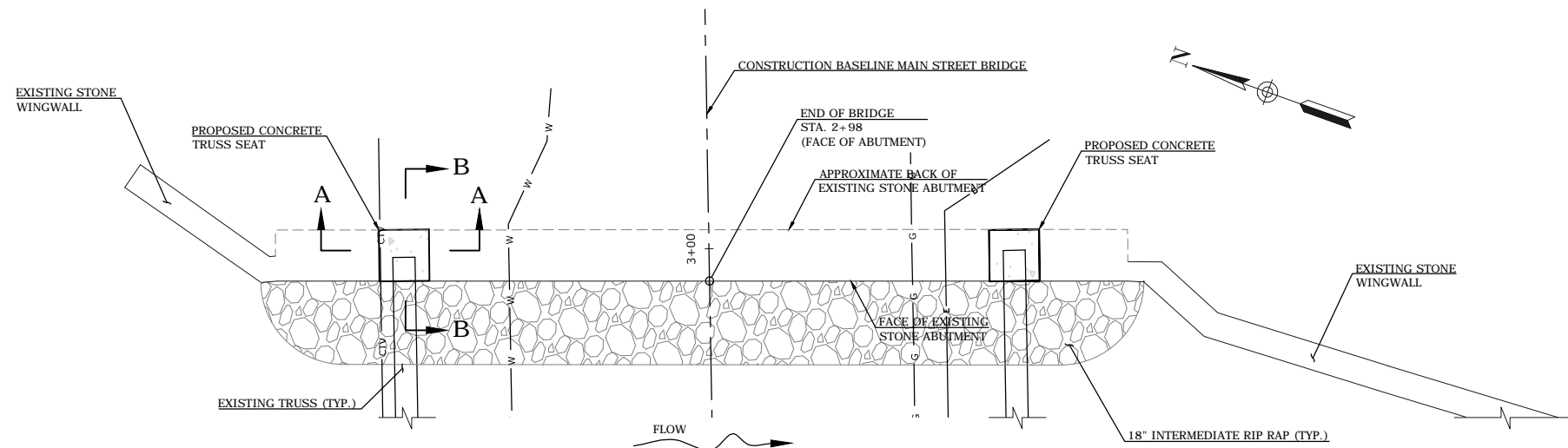

**EAST ABUTMENT PLAN**  
SCALE: 1" = 5'

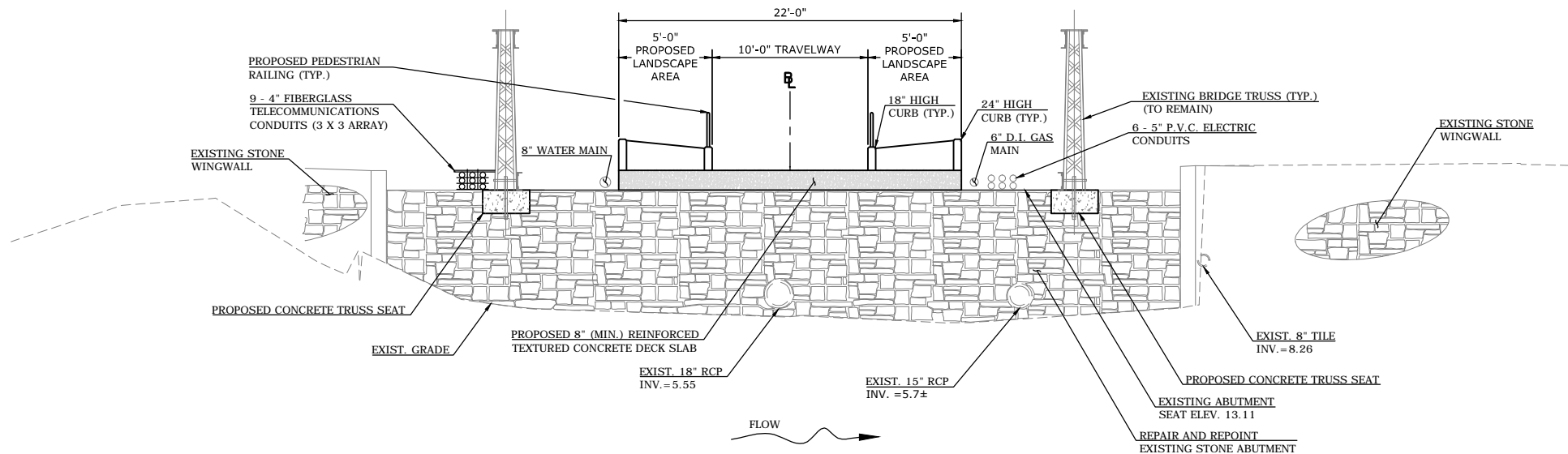

**EAST ABUTMENT ELEVATION VIEW  
(LOOKING EAST)**  
SCALE: 1" = 5'

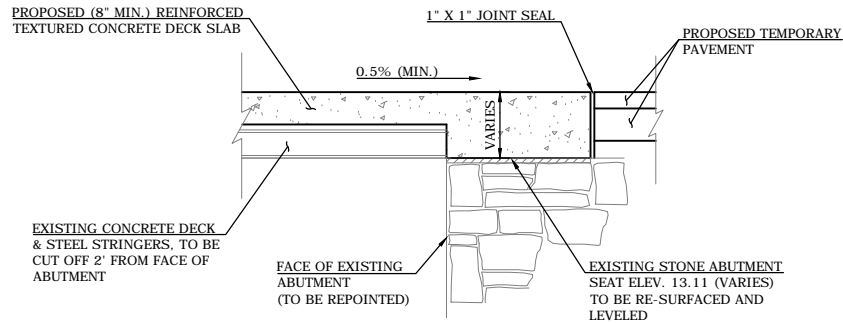
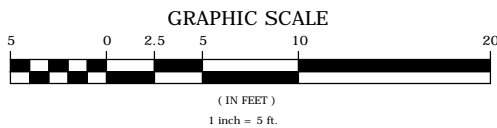

**EAST ABUTMENT SEAT DETAIL**  
SCALE: 1/2" = 1'-0"

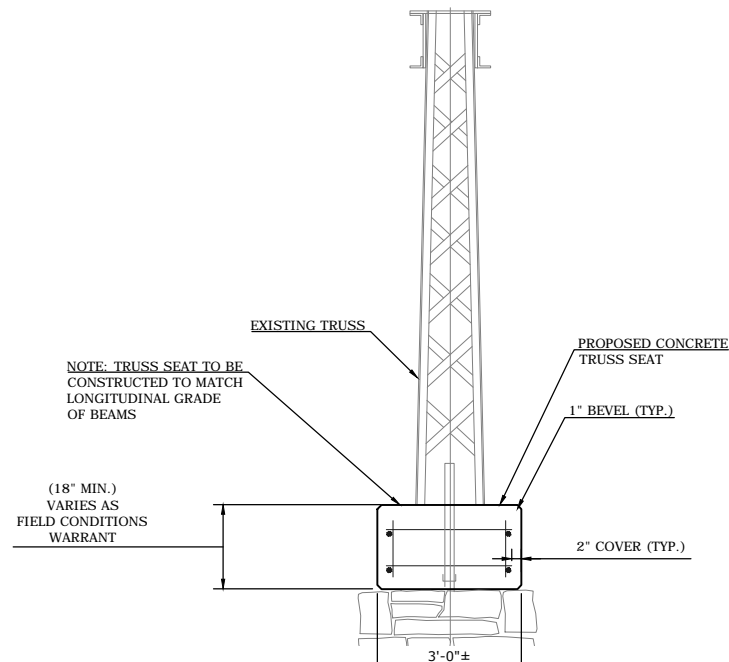

**TRUSS SEAT SECTION A -A**  
SCALE: 1/2" = 1'-0"

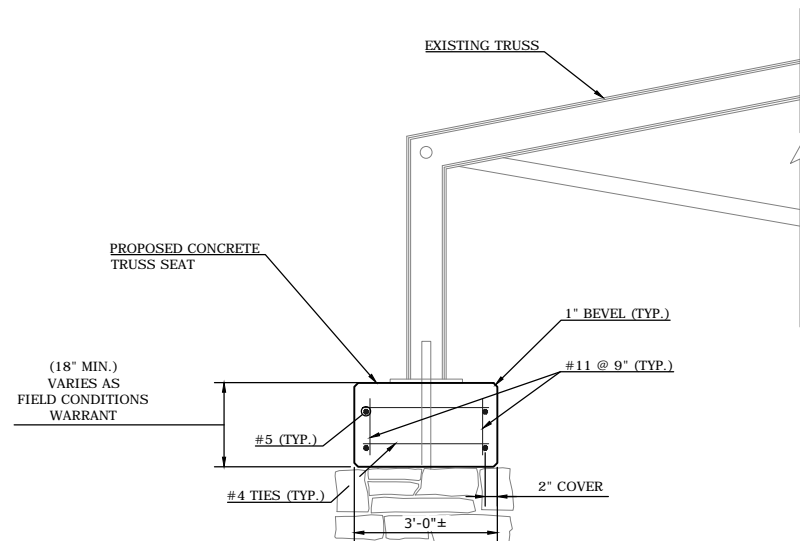

**TRUSS SEAT SECTION B -B**  
SCALE: 1/2" = 1'-0"

			SUPV.	J.A.C.
			DESIGN	J.A.W.
			DRAWN	S.A.M.
			CHECKED	J.A.W.
NO.	DATE	DESCRIPTION	DATE	12/20/2018
REVISIONS				

PE SUBMITTAL

1/2 SCALE  
(11X17)



• WENGELL, McDONNELL & COSTELLO •  
87 HOLMES ROAD  
NEWINGTON, CT 06111  
(860) 667-9624

PREPARED FOR  
CITY OF STAMFORD  
888 WASHINGTON BOULEVARD  
STAMFORD, CT. 06901

WEST MAIN STREET PEDESTRIAN BRIDGE  
MAIN STREET BRIDGE NO. 02212  
OVER RIPPOWAM RIVER  
EAST ABUTMENT PLAN & ELEVATION

D - MAIN STREET - P.E. - 18068.00 - SHEET A3  
SIZE PROJECT FILE NAME NUMBER REV. OF 5

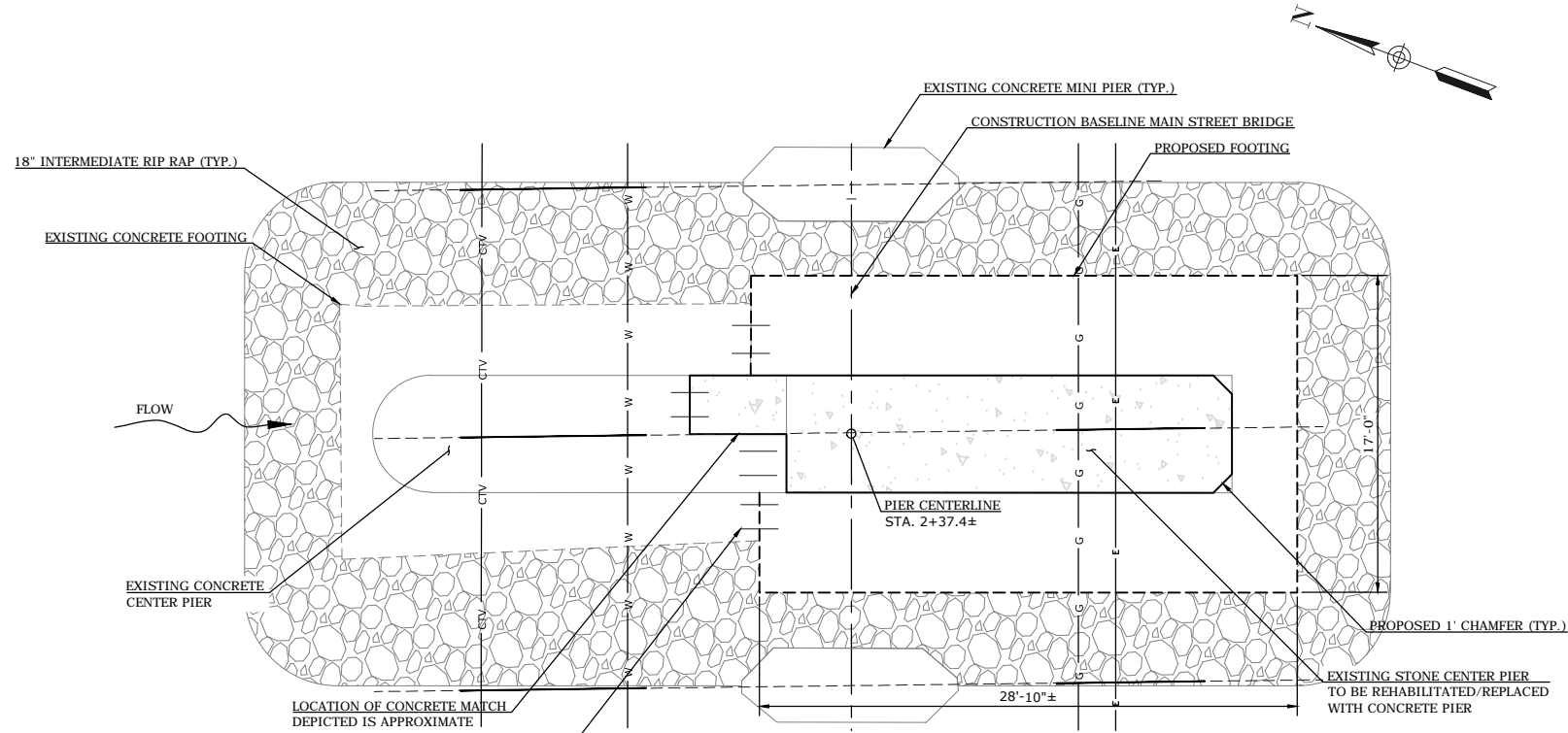

**CENTER PIER PLAN**  
SCALE: 1" = 5'

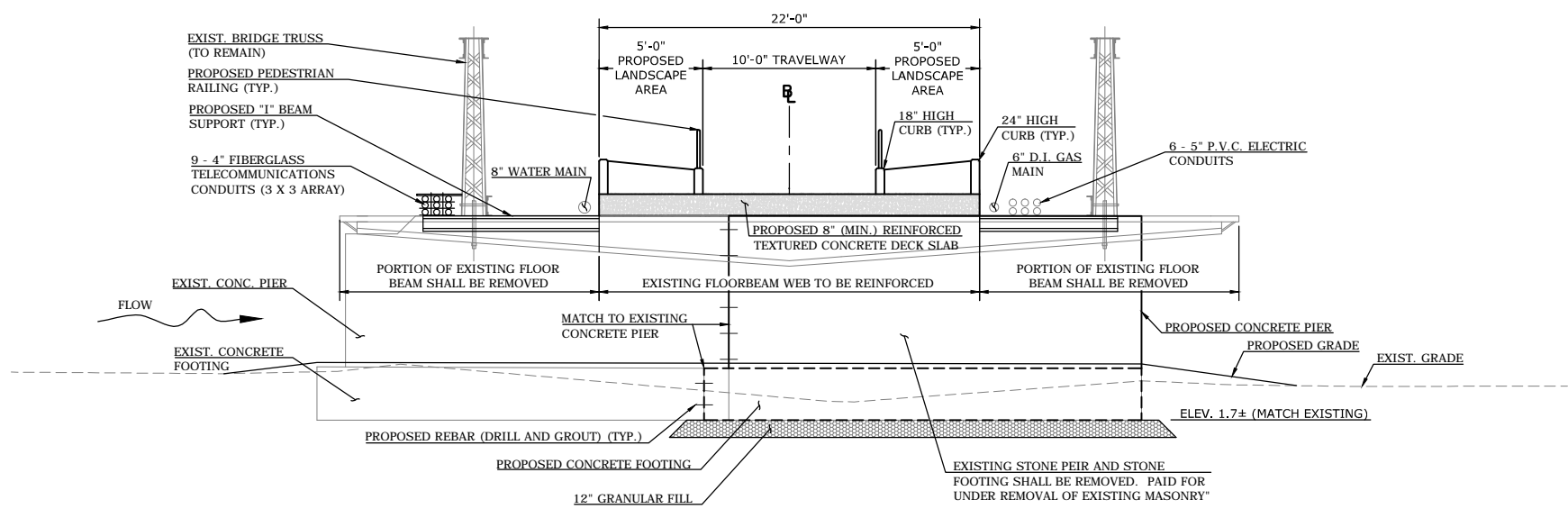

**CENTER PIER ELEVATION VIEW  
LOOKING EAST**  
SCALE: 1" = 5'

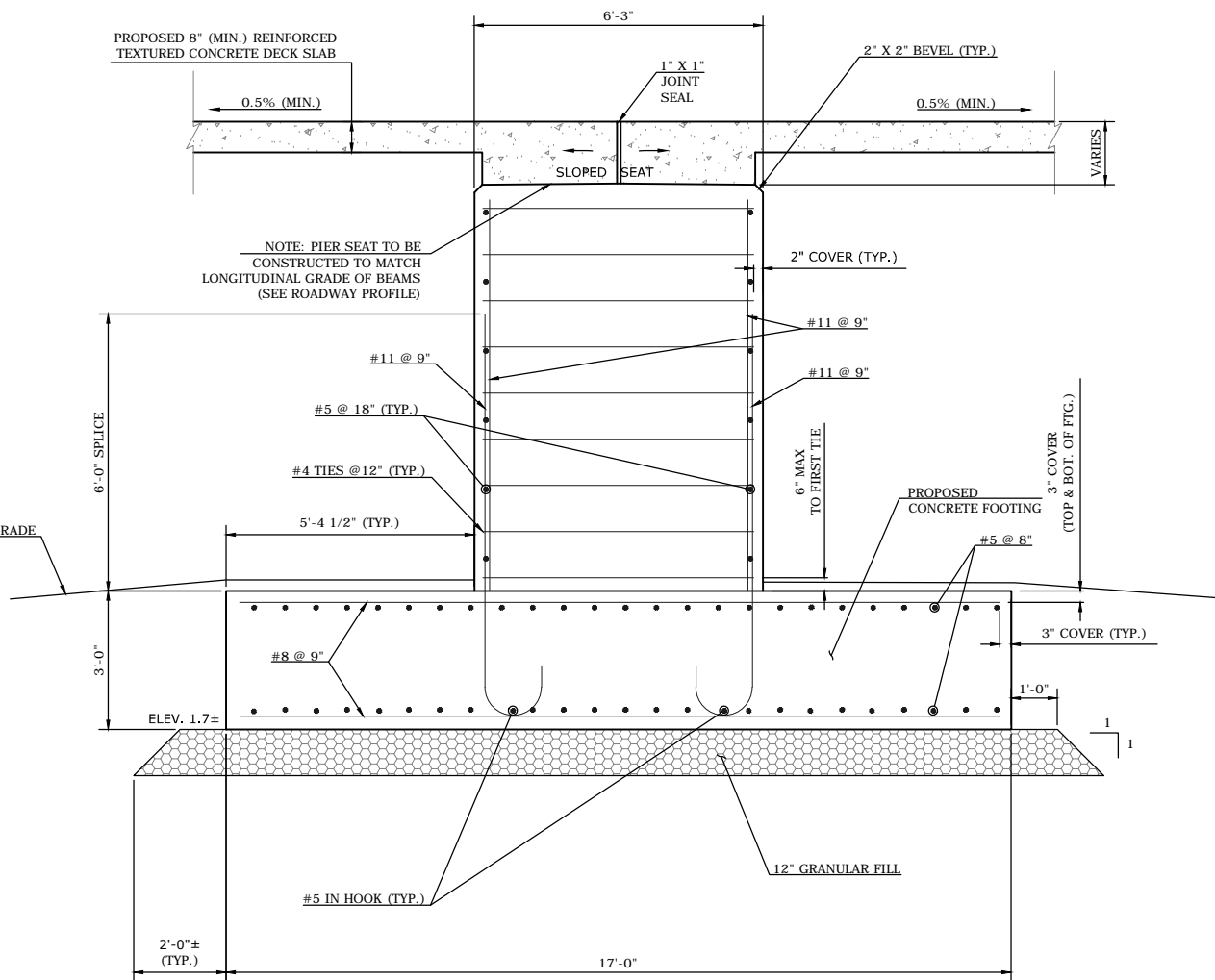

**CENTER PIER SECTION**  
SCALE: 1/2" = 1'-0"

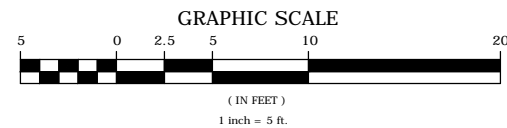

			SUPV.	J.A.C.
			DESIGN	J.A.W.
			DRAWN	S.A.M.
			CHECKED	J.A.W.
NO.	DATE	DESCRIPTION	DATE	12/20/2018
REVISIONS				

PE SUBMITTAL

1/2 SCALE  
(11X17)

**WMC**  
CONSULTING ENGINEERS

• WENGELL, McDONNELL & COSTELLO •  
87 HOLMES ROAD  
NEWINGTON, CT 06111  
(860) 667-9624

PREPARED FOR  
CITY OF STAMFORD  
888 WASHINGTON BOULEVARD  
STAMFORD, CT. 06901

WEST MAIN STREET PEDESTRIAN BRIDGE  
MAIN STREET BRIDGE NO. 02212  
OVER RIPPOWAM RIVER  
CENTER PIER PLAN & ELEVATION

D -	MAIN STREET	P.E.	18068.00	SHEET	A4
SIZE	PROJECT	FILE NAME	NUMBER	REV.	OF
					5

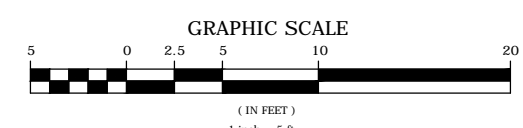
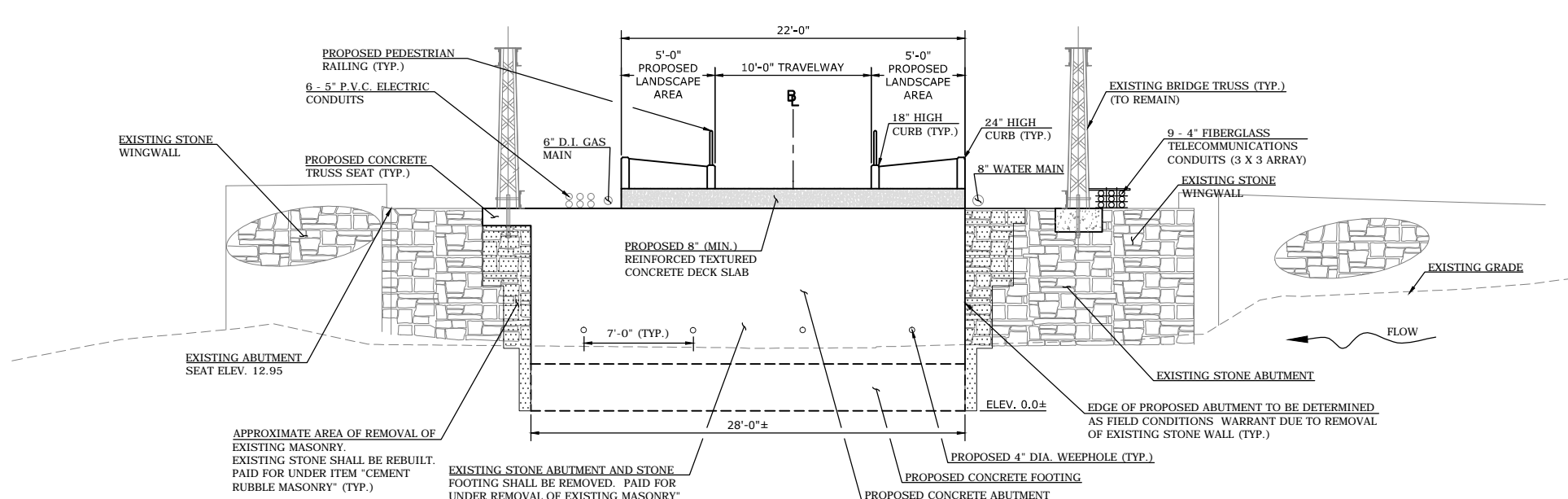
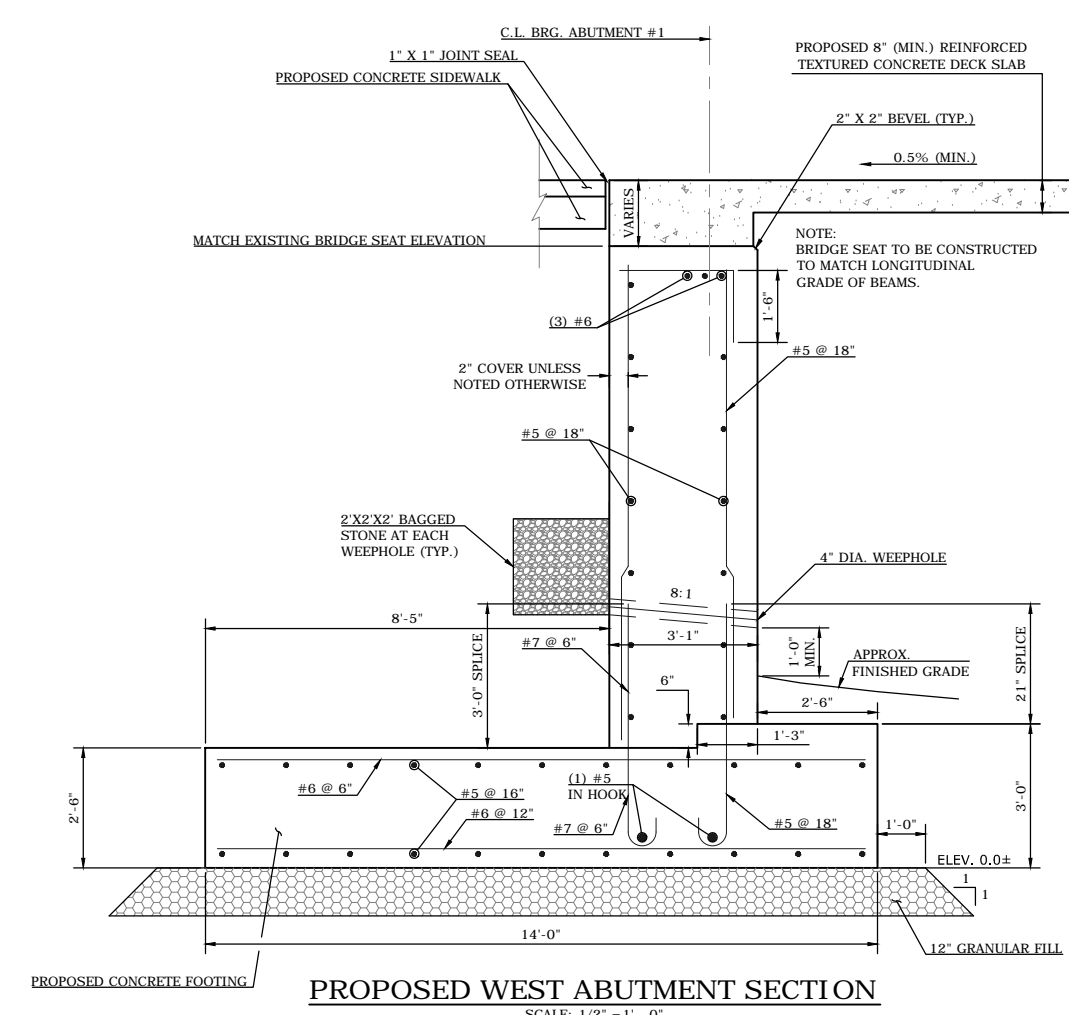
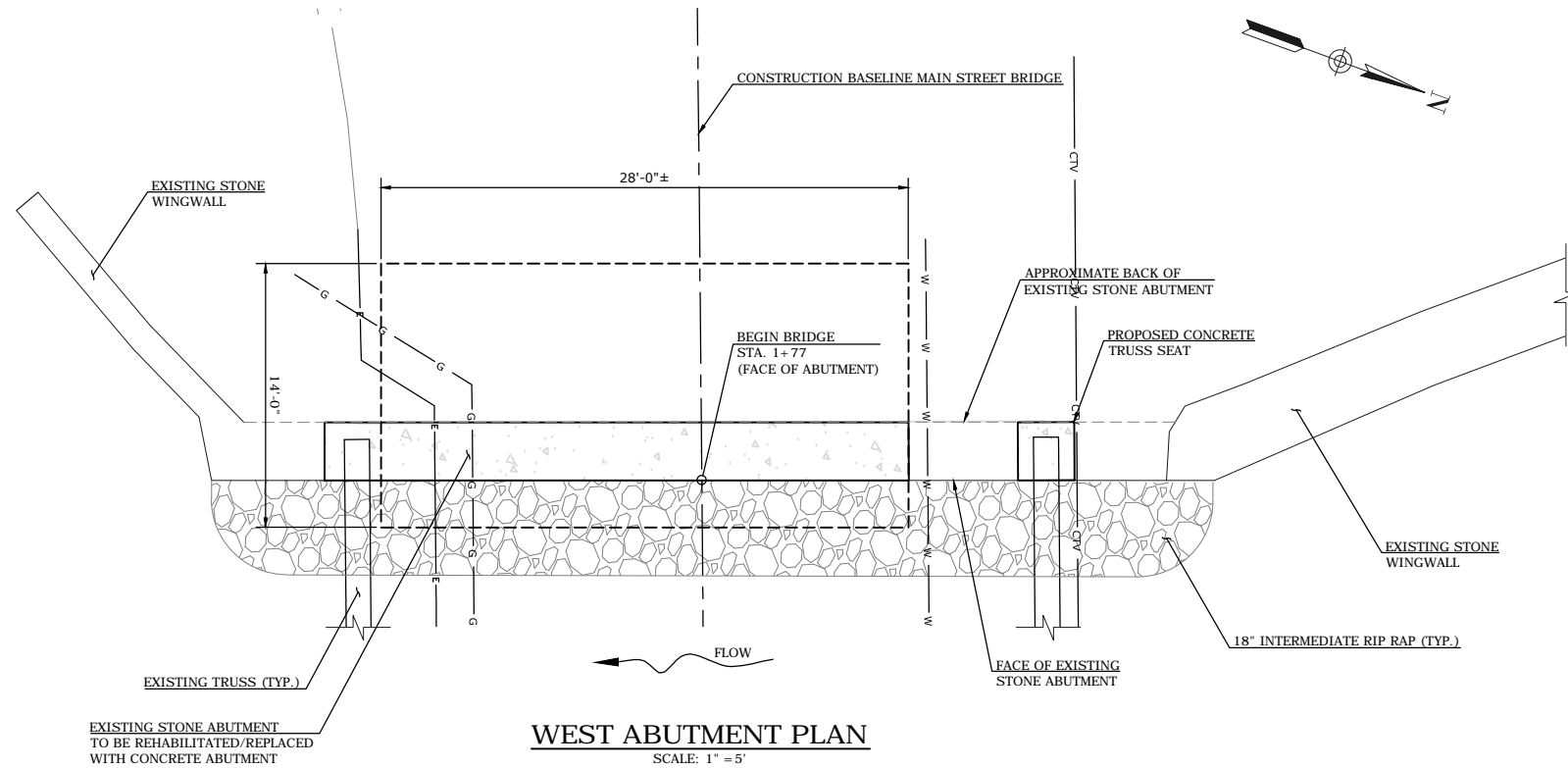

WEST ABUTMENT ELEVATION VIEW  
(LOOKING WEST)  
SCALE: 1" = 5'

			SUPV.	J.A.C.
			DESIGN	J.A.W.
			DRAWN	S.A.M.
			CHECKED	J.A.W.
NO.	DATE	DESCRIPTION	DATE	12/20/2018
REVISIONS				

PE SUBMITTAL

1/2 SCALE  
(11X17)

**WMC**  
CONSULTING ENGINEERS

• WENGELL, McDONNELL & COSTELLO •  
87 HOLMES ROAD  
NEWINGTON, CT 06111  
(860) 667-9624

PREPARED FOR  
CITY OF STAMFORD  
888 WASHINGTON BOULEVARD  
STAMFORD, CT. 06901

WEST MAIN STREET PEDESTRIAN BRIDGE MAIN STREET BRIDGE NO. 02212 OVER RIPPOWAM RIVER WEST ABUTMENT PLAN & ELEVATION					SHEET	A5
D -	MAIN STREET	P.E.	18068.00			
SIZE	PROJECT	FILE NAME	NUMBER	REV.	OF	5