

Proposed Area of Future
School Based Health Clinic

1 FLOOR PLAN: PARTIAL EXISTING FIRST FLOOR

1/8" = 1'-0"

Date: 05/16/2023 Scale: AS NOTED Drawn By: JAC Check: JAC Plot Number: 2514	EX01
TURN OF RIVER MIDDLE SCHOOL PARTIAL EXISTING FLOOR PLAN	
SILVER PETRUCELLI + ASSOCIATES 3190 WHITNEY AVENUE, HAMDEN CT 06518 311 STATE STREET NEW LONDON CT 06320 203 239 9907 sil@petrucelli.com	
CLIENT: FAMILY CENTERS INC. TURN OF RIVER MIDDLE SCHOOL SCHOOL-BASED HEALTH CENTER PROJECT 17 WINE ROAD STAMFORD, CONNECTICUT 06905	

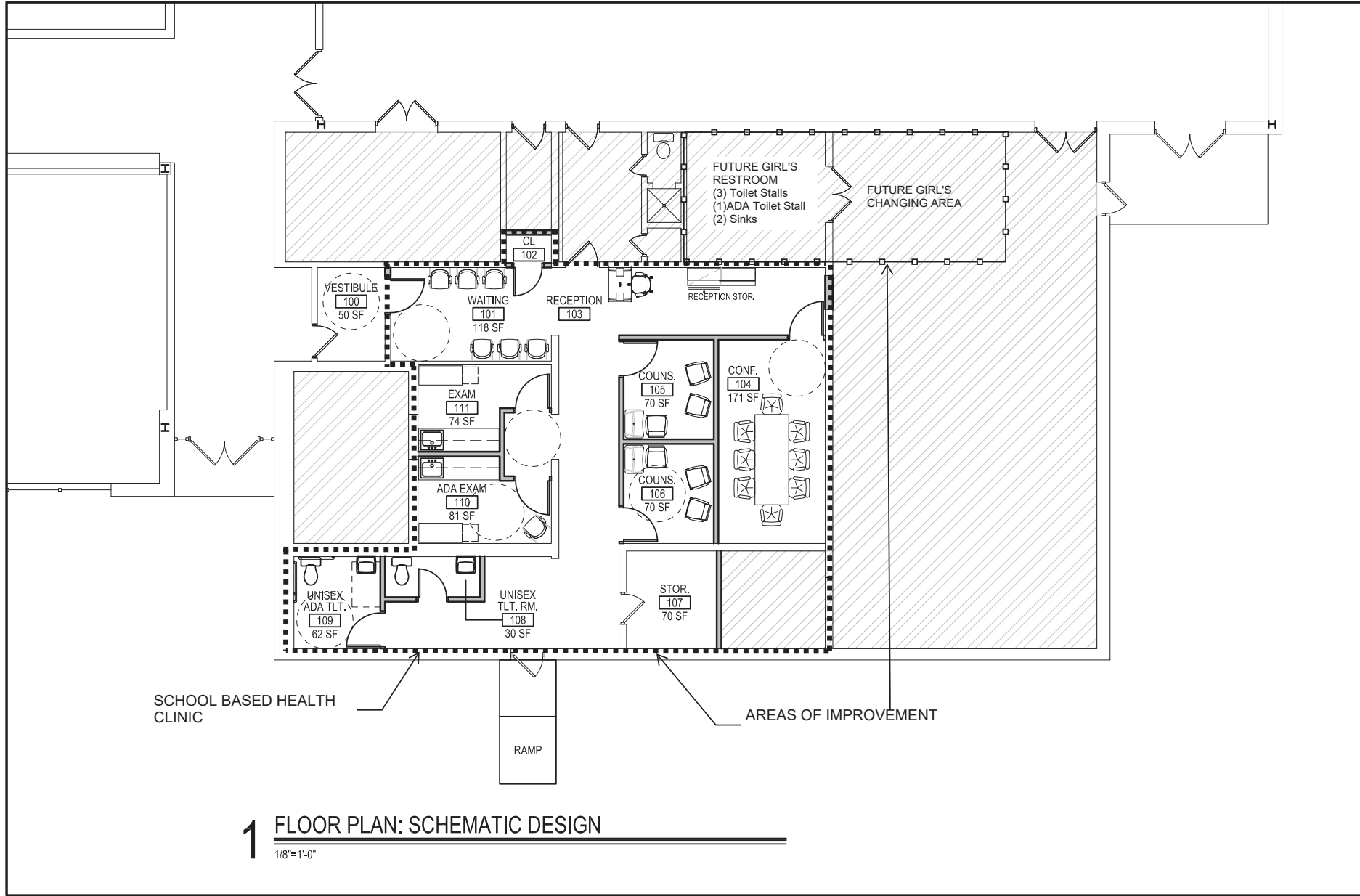

1 FLOOR PLAN: SCHEMATIC DESIGN

1/8"=1'-0"

Project No. 2025062023	Date 08/14/2025	Scale AS NOTED	Drawing No. 01	Sheet No. 01	Project Name SD01
SILVER PETRUCELLI + ASSOCIATES 3190 WHITNEY AVENUE, HAMDEN CT 06518 311 STATE STREET NEW LONDON CT 06320 203 239 9907 silverpetrucci.com					
TURN OF RIVER MIDDLE SCHOOL SCHOOL-BASED HEALTH CLINIC SCHEMATIC DESIGN FLOOR PLAN					
Client: FAMILY CENTERS INC. TURN OF RIVER MIDDLE SCHOOL Project: SCHOOL-BASED HEALTH CENTER PROJECT Location: 17 WINE ROAD, STAMFORD, CONNECTICUT 06905					